

BRUSHLESS SERVO MOTORS

GMBF5000 SERIES MECHANICAL DIMENSIONS

	DIM. "A" - INCH [mm]
GMBF5030	11.59 [294.4mm]
GMBF5040	11.96 [303.8mm]
GMBF5060	14.60 [370.8mm]

MECHANICAL NOTES:

1. AXIAL LOAD: 50 LBS. [23 kg.] MAX.
2. RADIAL LOAD: 100 LBS. [45 kg.] MAX.
@ 1" [25mm] FROM FACE.
3. BRAKE MOTOR= DIM. "A" + 2.00 [51mm]

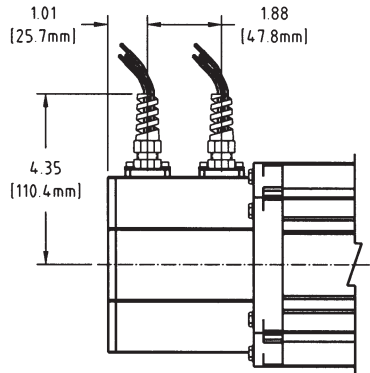

LIQUID TIGHT STRAIN RELIEF WITH FLYING LEADS

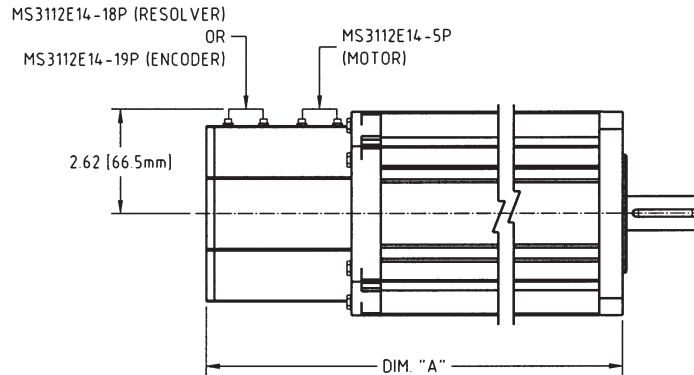

MS CONNECTORS

ENGLISH MOTOR

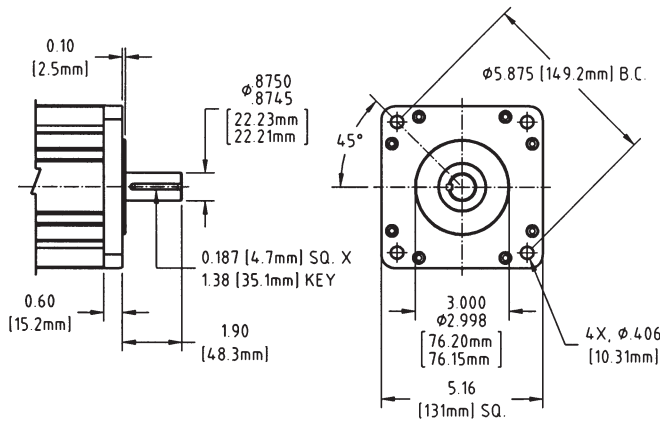

METRIC MOTOR

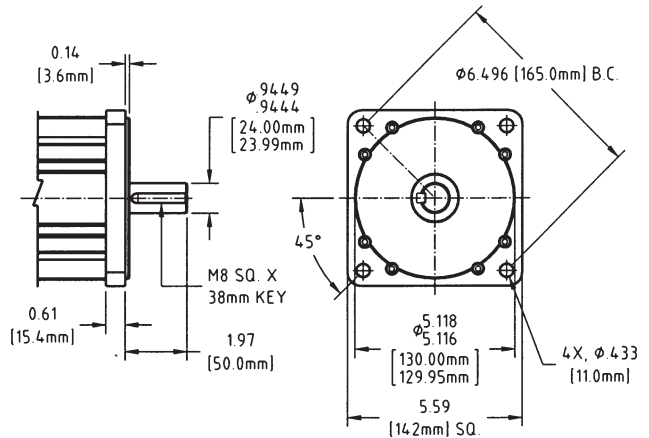

NEMA 56C MOTOR

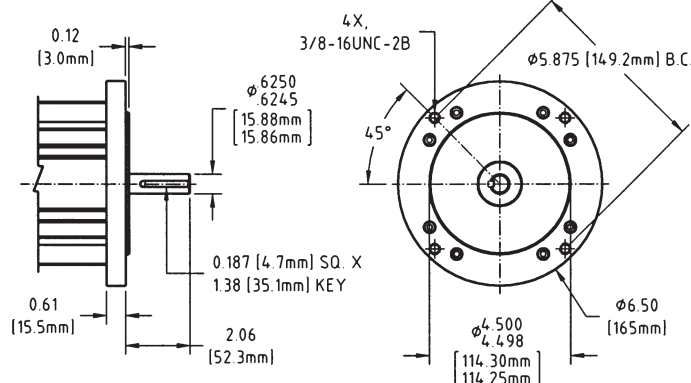

Glentek, Inc.

208 Standard Street • El Segundo, California 90245 USA
(310) 322-3026 • (310) 322-7709 Fax • www.glentek.com